

Legend
 ORDER LIMITS
 AREA COVERED BY SHEET AS REFERENCED

P07	15.05.20	Amended following s61 advice	RP	SRH	SRH
P06	05.03.20	Site compound work rows amended	SRH	RP	SRH
P05	11.02.20	DCO Submission	RP	SRH	SRH
P04	23.01.20	Updated following consultation	RP	SRH	SRH
P03	12.09.20	Minor amendments	JFP	SRH	SRH
P02	29.08.20	Amended following legal review	JFP	SRH	SRH
P01	31.07.20	Preliminary Issue	JFP	SRH	SRH
Issue	Date	Details of Issue / Revision	Drawn	Checked	Approved
Issues & Revisions					
Client					
 OXFORDSHIRE STRATEGIC RAIL FREIGHT INTERCHANGE					
THE OXFORDSHIRE STRATEGIC RAIL FREIGHT INTERCHANGE AND HIGHWAYS ORDER 202X					
Drawing Title					
WORKS PLANS KEY PLAN					
Regulation	5(2) (j)	Document	2.2		
Drawn	J. Palmer	Checked	S. Hilditch		
Approved	S. Hilditch	Date	31.07.2025		
BWB Ref	NTH2479	Scale	1:10,000		
Project - Original - Functional Breakdown - Spatial Breakdown - Form - Discipline - Number					
OxSRFI-BWB-LSI-XX-DR-CH-00160					
Drawing Status					
DCO SUBMISSION					
Rev	P07				

© Crown copyright and database rights 2025 OS. All rights reserved. You are not permitted to copy, sub-license, distribute or sell any of this data to third parties in any form.



Legend (Sheet 1)

WORK No. REFERENCE

- WORK No. 14A - M40 JUNCTION 10 PHASE 1
- WORK No. 14B - M40 JUNCTION 10 PHASE 2
- WORK No. 14B AND WORK No. 14A
- WORK No. 15B - A43 TRUNK ROAD PHASE 2
- WORK No. 16 - A43 BAYNARD'S GREEN JUNCTION ALTERNATIVE
- WORK No. 16A - A43 BAYNARD'S GREEN JUNCTION ALTERNATIVE
- WORK No. 16 and WORK No. 15B
- WORK No. 17 - B4100
- ORDER LIMITS
- X WORK NUMBER: REFER TO SCHEDULE 1 OF THE DEVELOPMENT CONSENT ORDER.

- NOTES**
1. WORK No. AREAS ARE DESCRIBED IN SCHEDULE 1 OF THE DEVELOPMENT CONSENT ORDER.
 2. THE LIMITS OF DEVIATION ARE THE FULL EXTENT OF THE WORK SHOWN. PLEASE REFER ALSO TO ARTICLE 4 OF THE DEVELOPMENT CONSENT ORDER.

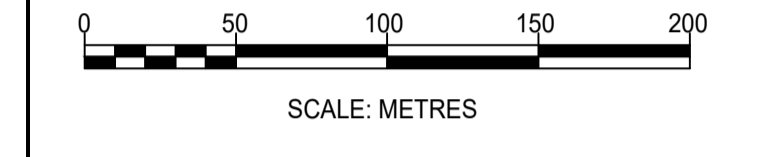

Rev	Date	Details of issue / revision	Drw	CR'd	Apv
P05	05.03.26	Work no. 16A minor boundary change	SRH	RP	SRH
P04	11.02.26	DCO Submission	RP	SRH	SRH
P03	23.01.26	Updated following consultation	RP	SRH	SRH
P02	29.08.25	Amended following legal review	JFP	SRH	SRH
P01	31.07.25	Preliminary Issue	JFP	SRH	SRH

Issues & Revisions



THE OXFORDSHIRE STRATEGIC RAIL FREIGHT INTERCHANGE AND HIGHWAYS ORDER 202X

WORKS PLANS SHEET 1 OF 10

Regulation:	5(2) (j)	Document:	2.2A
Drawn:	J.Palmer	Checked:	S.Hilditch
Approved:	S.Hilditch	Date:	31.07.2025
BWB Ref:	NTH2479	Scale@A1:	1:2500

Project - Originator - Functional Breakdown - Spatial Breakdown - Form - Discipline - Number
OxSRFI-BWB-LSI-01-DR-CH-0161

Drawing Status	Rev
DCO SUBMISSION	P05

See Sheet 3

See Sheet 10



See Sheet 3

- Legend (Sheet 2)**
- WORK No. REFERENCE
 - WORK No. 1 - RAILWAY WORKS TO THE EXISTING CHILTERN MAIN LINE
 - WORK No. 2 - PRIVATE RAILWAY
 - WORK No. 2 LIMITS OF DEVIATION
 - WORK No. 8 OVER WORK No. 2
 - WORK No. 3 - RAIL TERMINAL
 - WORK No. 4 - RAIL TERMINAL OR RAIL SERVED WAREHOUSING
 - WORK No. 8 - LANDSCAPING
 - WORK No. 26 - QUARRY COTTAGES TURNING HEAD AND BRIDLEWAY
 - WORK No. 26 OVER WORK No. 1
 - WORK No. 28 - AVES DITCH (NORTH)
 - WORK No. 29 - ECOLOGICAL MITIGATION AREA (MAIN SITE)
 - WORK No. 37 - ECOLOGICAL MITIGATION AREA (NORTH OF ARDLEY ROAD)
 - WORK No. 38 - ARDLEY TUNNEL
 - ORDER LIMITS
 - X WORK NUMBER: REFER TO SCHEDULE 1 OF THE DEVELOPMENT CONSENT ORDER.

NOTES

1. WORK No. AREAS ARE DESCRIBED IN SCHEDULE 1 OF THE DEVELOPMENT CONSENT ORDER.
2. THE LIMITS OF DEVIATION ARE THE FULL EXTENT OF THE WORKS SHOWN SAVE FOR WORK No. 2 THE LIMITS OF DEVIATION OF WHICH ARE AS SHOWN ON THESE PLANS. PLEASE REFER ALSO TO ARTICLE 4 OF THE DEVELOPMENT CONSENT ORDER.

0 50 100 150 200
SCALE: METRES

P05	11.02.26	DCO Submission	RP	SRH	SRH
P04	23.01.26	Updated following consultation	RP	SRH	SRH
P03	12.09.25	Minor amendments	JFP	SRH	SRH
P02	29.08.25	Amended following legal review	JFP	SRH	SRH
P01	31.07.25	Preliminary Issue	JFP	SRH	SRH
Rev	Date	Details of issue / revision	Drw	CR'G	APV

Issues & Revisions

Client



THE OXFORDSHIRE STRATEGIC RAIL FREIGHT INTERCHANGE AND HIGHWAYS ORDER 202X

WORKS PLANS SHEET 2 OF 10

Regulation:	5(2) (j)	Document:	2.2B
Drawn:	J.Palmer	Checked:	S.Hilditch
Approved:	S.Hilditch	Date:	31.07.2025
BWB Ref:	NTH2479	Scale@A1:	1:2500
Project - Originator - Functional Breakdown - Spatial Breakdown - Form - Discipline - Number			
OxSRFI-BWB-LSI-02-DR-CH-0162			

Drawing Status: **DCO SUBMISSION** Rev: **P05**

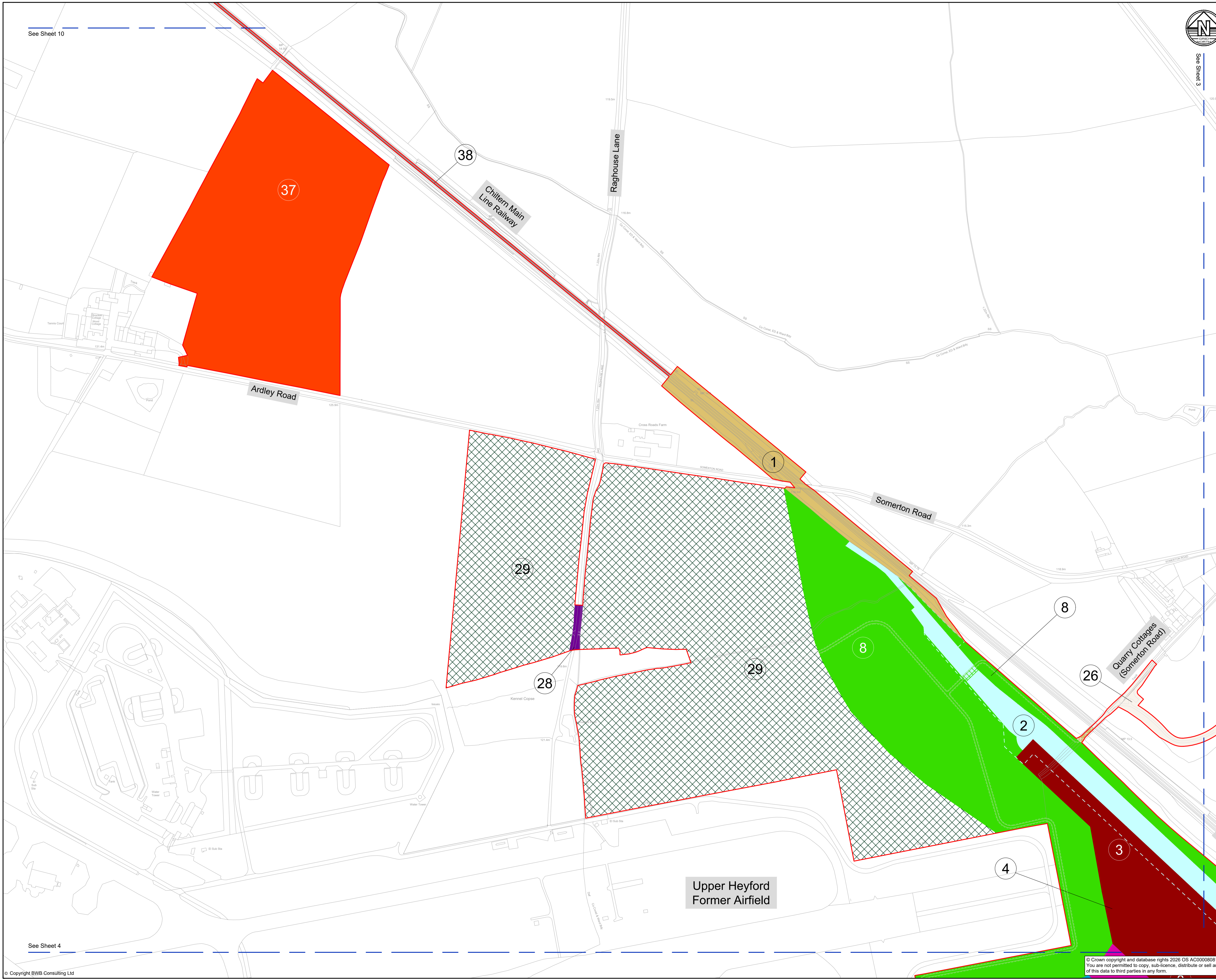

See Sheet 4

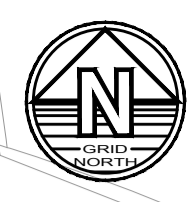
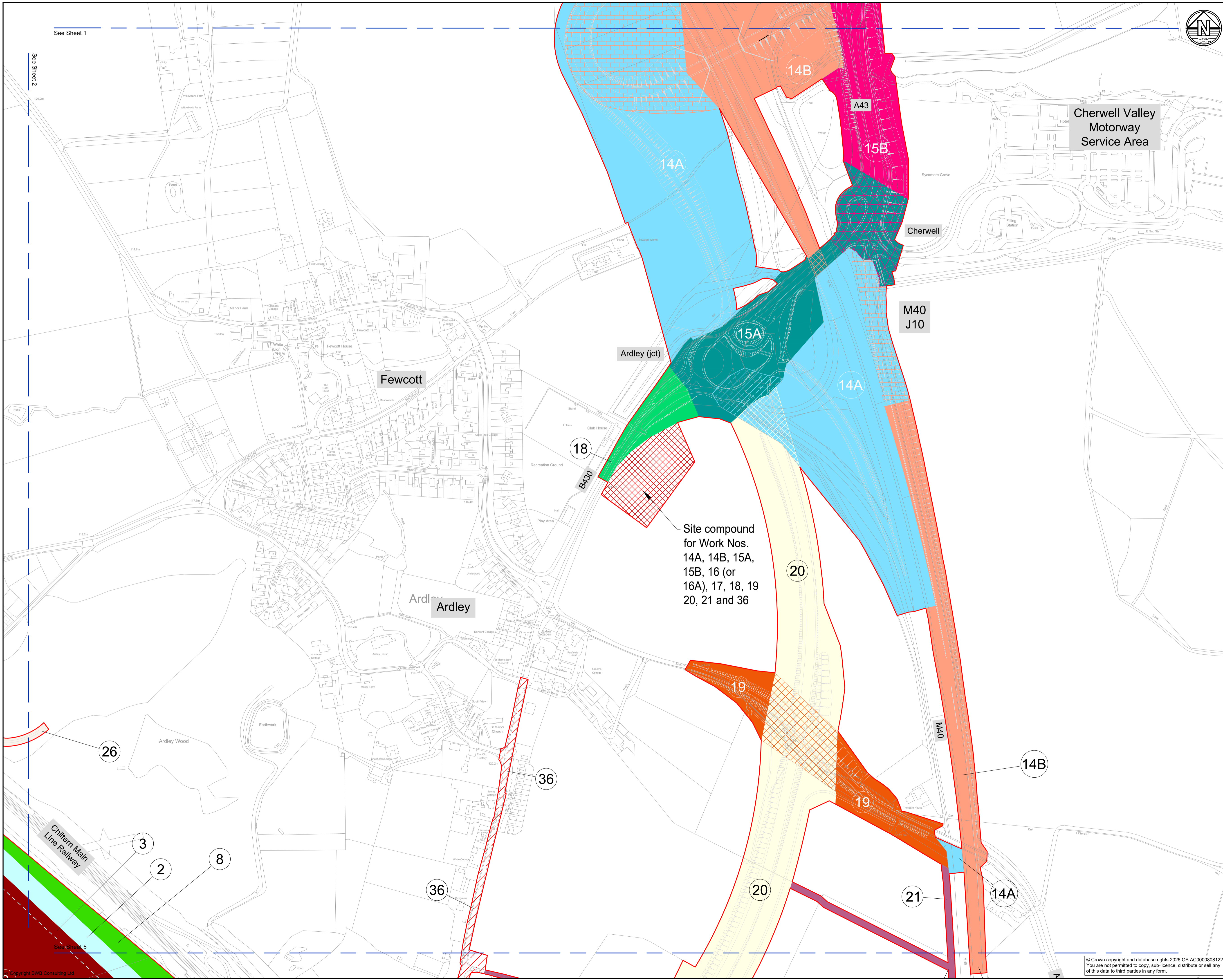

Legend (Sheet 3)

WORK No. REFERENCE

- WORK No. 2 - PRIVATE RAILWAY
- WORK No. 2 LIMITS OF DEVIATION
- WORK No. 3 - RAIL TERMINAL
- WORK No. 8 - LANDSCAPING
- WORK No. 14A - M40 J10 PHASE 1
- WORK No. 14B - M40 J10 PHASE 2
- WORK No. 14B AND WORK No. 14A
- WORK No. 15A OVER WORK No. 14B
- WORK No. 14A AND WORK No. 15A
- WORK No. 15A - A43 TRUNK ROAD PHASE 1
- WORK No. 15B - A43 TRUNK ROAD PHASE 2
- WORK No. 15B AND WORK No. 15A
- WORK No. 18 - B430 SOUTH OF ARDLEY ROUNDABOUT
- WORK No. 19 - ARDLEY ROAD
- WORK No. 20 - ARDLEY BYPASS
- WORK No. 20 AND WORK No. 14
- WORK No. 19 AND WORK No. 20
- WORK No. 21 - ARDLEY BYPASS PROw
- WORK No. 26 - QUARRY COTTAGES TURNING HEAD AND BRIDLEWAY
- WORK No. 36 - B430 STATION ROAD
- SITE COMPOUND FOR WORKS AS DESCRIBED
- ORDER LIMITS
- X WORK NUMBER: REFER TO SCHEDULE 1 OF THE DEVELOPMENT CONSENT ORDER.

NOTES

1. WORK No. AREAS ARE DESCRIBED IN SCHEDULE 1 OF THE DEVELOPMENT CONSENT ORDER.
2. THE LIMITS OF DEVIATION ARE THE FULL EXTENT OF THE WORKS SHOWN SAVE FOR WORK No. 2 THE LIMITS OF DEVIATION OF WHICH ARE AS SHOWN ON THESE PLANS. PLEASE REFER ALSO TO ARTICLE 4 OF THE DEVELOPMENT CONSENT ORDER.

0 50 100 150 200
SCALE: METRES

P06	05.03.26	Site compound work nos. amended	SRH	RP	SRH
P05	11.02.26	DCO Submission	RP	SRH	SRH
P04	23.01.26	Updated following consultation	RP	SRH	SRH
P03	12.09.25	Minor amendments	JFP	SRH	SRH
P02	29.08.25	Amended following legal review	JFP	SRH	SRH
P01	31.07.25	Preliminary Issue	JFP	SRH	SRH
Rev	Date	Details of issue / revision	Drw	CRG	APV

Issues & Revisions

Client

Project Title

THE OXFORDSHIRE STRATEGIC RAIL FREIGHT INTERCHANGE AND HIGHWAYS ORDER 202X

Drawing Title

WORKS PLANS SHEET 3 OF 10

Regulation:	5(2) (j)	Document:	2.2C
Drawn:	J.Palmer	Checked:	S.Hilditch
Approved:	S.Hilditch	Date:	31.07.25
BWB Ref:	NTH2479	Scale@A1:	1:2500
Project - Originator - Functional Breakdown - Spatial Breakdown - Form - Discipline - Number			
OxSRFI-BWB-LSI-03-DR-CH-0163			

Drawing Status

DCO SUBMISSION

Rev
P06

© Crown copyright and database rights 2026 OS AC0000808122. You are not permitted to copy, sub-licence, distribute or sell any of this data to third parties in any form.

See Sheet 2

Upper Heyford
Former Airfield

Heyford
Park

Camp Road



Legend (Sheet 4)

- WORK No. REFERENCE
- WORK No. 3 - RAIL TERMINAL
- WORK No. 4 - RAIL TERMINAL OR RAIL SERVED WAREHOUSING
- WORK No. 6 - RAIL SERVED WAREHOUSING
- WORK No. 7A - ESTATE ROAD (EXCLUDING SOUTHERN LINK)
- WORK No. 7B - ESTATE ROAD (SOUTHERN LINK)
- WORK No. 7A LIMITS OF DEVIATION
- WORK No. 7B LIMITS OF DEVIATION
- WORK No. 8 - LANDSCAPING
- WORK No. 8 LIMITS OF DEVIATION
- WORK No. 9 - CENTRAL HUB
- WORK No. 10 - CHILGROVE DRIVE
- WORK No. 12A - HEYFORD PARK LINK ROAD (WESTERN SECTION)
- WORK No. 12B - HEYFORD PARK LINK ROAD (EASTERN SECTION)
- WORK No. 12A LIMITS OF DEVIATION
- WORK No. 12B LIMITS OF DEVIATION
- WORK No. 12B AND WORK No. 12A
- WORK No. 13A - AVES DITCH BRIDLEWAY CONNECTION
- WORK No. 13B - CAMP ROAD/CHILGROVE DRIVE JUNCTION
- WORK No. 30 - BIODIVERSITY AND LANDSCAPING ENHANCEMENT AREA (SOUTH)
- ORDER LIMITS
- WORK NUMBER: REFER TO SCHEDULE 1 OF THE DEVELOPMENT CONSENT ORDER.

NOTES

1. WORK No. AREAS ARE DESCRIBED IN SCHEDULE 1 OF THE DEVELOPMENT CONSENT ORDER.
2. THE LIMITS OF DEVIATION ARE THE FULL EXTENT OF THE WORKS SHOWN SAVE FOR WORK Nos. 7A, 7B, 8, 12A AND 12B THE LIMITS OF DEVIATION OF WHICH ARE AS SHOWN ON THESE PLANS. PLEASE REFER ALSO TO ARTICLE 4 OF THE DEVELOPMENT CONSENT ORDER.

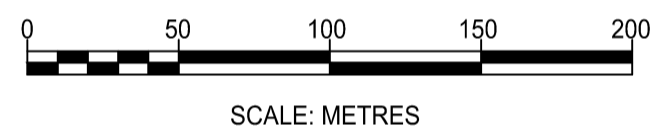

P05	11.02.26	DCO Submission	RP	SRH	SRH
P04	23.01.26	Updated following consultation	RP	SRH	SRH
P03	12.09.25	Minor amendments	JFP	SRH	SRH
P02	29.08.25	Amended following legal review	JFP	SRH	SRH
P01	31.07.25	Preliminary Issue	JFP	SRH	SRH
Rev	Date	Details of issue / revision	Drw	CRG	APV

Issues & Revisions

Client

OXFORDSHIRE
STRATEGIC RAIL FREIGHT INTERCHANGE

Project Title

THE OXFORDSHIRE STRATEGIC RAIL FREIGHT INTERCHANGE AND HIGHWAYS ORDER 202X

Drawing Title

WORKS PLANS SHEET 4 OF 10

Regulation:	5(2) (j)	Document:	2.2D
Drawn:	J.Palmer	Checked:	S.Hilditch
Approved:	S.Hilditch	Date:	31.07.2025
BWB Ref:	NTH2479	Scale@A1:	1:2500

Project - Originator - Functional Breakdown - Spatial Breakdown - Form - Discipline - Number

OxSRFI-BWB-LSI-04-DR-CH-0164

Drawing Status: **DCO SUBMISSION** Rev: **P05**

© Crown copyright and database rights 2026 OS AC0000808122. You are not permitted to copy, sub-licence, distribute or sell any of this data to third parties in any form.

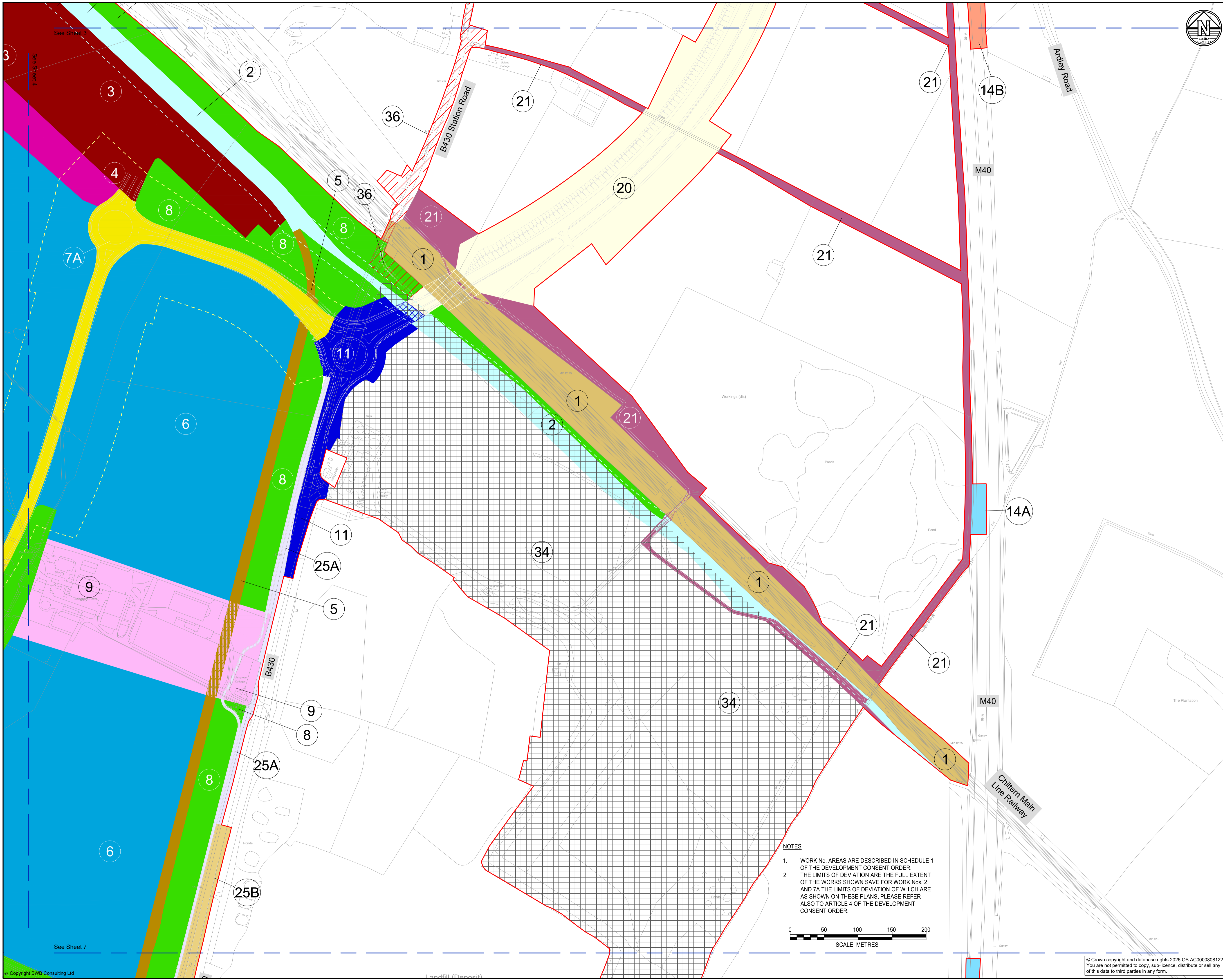

Legend (Sheet 5)

- WORK No. REFERENCE
- WORK No. 1 - RAILWAY WORKS TO EXISTING CHILTERN MAIN LINE
 - WORK No. 20 OVER WORK No. 1
 - WORK No. 20 OVER WORK No. 1; WORK No. 21
 - WORK No. 36 OVER WORK No. 1
 - WORK No. 2 - PRIVATE RAILWAY
 - WORKS No. 2 LIMITS OF DEVIATION
 - WORK No. 3 - RAIL TERMINAL
 - WORK No. 4 - RAIL TERMINAL OR RAIL SERVED WAREHOUSING
 - WORK No. 5 - RAIL SIDINGS (WAREHOUSING)
 - WORK No. 6 - RAIL SERVED WAREHOUSING
 - WORK No. 7A - ESTATE ROAD (EXCLUDING SOUTHERN LINK)
 - WORK No. 7A LIMITS OF DEVIATION
 - WORK No. 8 - LANDSCAPING
 - WORK No. 9 - CENTRAL HUB
 - WORK No. 9 AND WORK No. 5
 - WORK No. 9 AND WORK No. 25A
 - WORK No. 11 - PRINCIPAL ACCESS TO THE MAIN SITE
 - WORK No. 14A - M40 J10 PHASE 1
 - WORK No. 20 - ARDLEY BYPASS
 - WORK No. 36 - B430 STATION ROAD
 - WORK No. 21 - ARDLEY BYPASS PRoW
 - WORK No. 21 AND WORK No. 1
 - WORK No. 25A - B430 ACTIVE TRAVEL ROUTE
 - WORK No. 25B - B430 UPPER HEYFORD ROAD JUNCTION
 - WORK No. 34 - LANDFILL WORKS
 - WORK No. 1 AND WORK No. 34
 - WORK No. 2 AND WORK No. 34
 - WORK No. 34; WORK No. 11 OVER WORK No. 2
 - WORK No. 11 AND WORK No. 34
 - WORK No. 34; WORK No. 21 OVER WORK No. 2
 - WORK No. 21 AND WORK No. 34
 - WORK No. 36 AND WORK No. 8
 - ORDER LIMITS
 - X WORK NUMBER: REFER TO SCHEDULE 1 OF THE DEVELOPMENT CONSENT ORDER.

P05	11.02.26	DCO Submission	RP	SRH	SRH
P04	23.01.26	Updated following consultation	RP	SRH	SRH
P03	12.09.25	Minor amendments	JFP	SRH	SRH
P02	29.08.25	Amended following legal review	JFP	SRH	SRH
P01	31.07.25	Preliminary Issue	JFP	SRH	SRH
Rev	Date	Details of issue / revision	Drw	CRG	APV

Issues & Revisions

Client

THE OXFORDSHIRE STRATEGIC RAIL FREIGHT INTERCHANGE AND HIGHWAYS ORDER 202X

WORKS PLANS SHEET 5 OF 10

Regulation:	5(2) (j)	Document:	2.2E
Drawn:	J.Palmer	Checked:	S.Hilditch
Approved:	S.Hilditch	Date:	31.07.25
BWB Ref:	NTH2479	Scale@A1:	1:2500
Project - Originator - Functional Breakdown - Spatial Breakdown - Form - Discipline - Number			
OxSRFI-BWB-LSI-05-DR-CH-0165			

Drawing Status	Rev
DCO SUBMISSION	P05

NOTES

1. WORK No. AREAS ARE DESCRIBED IN SCHEDULE 1 OF THE DEVELOPMENT CONSENT ORDER.
2. THE LIMITS OF DEVIATION ARE THE FULL EXTENT OF THE WORKS SHOWN SAVE FOR WORK Nos. 2 AND 7A THE LIMITS OF DEVIATION OF WHICH ARE AS SHOWN ON THESE PLANS. PLEASE REFER ALSO TO ARTICLE 4 OF THE DEVELOPMENT CONSENT ORDER.

0 50 100 150 200
SCALE: METRES

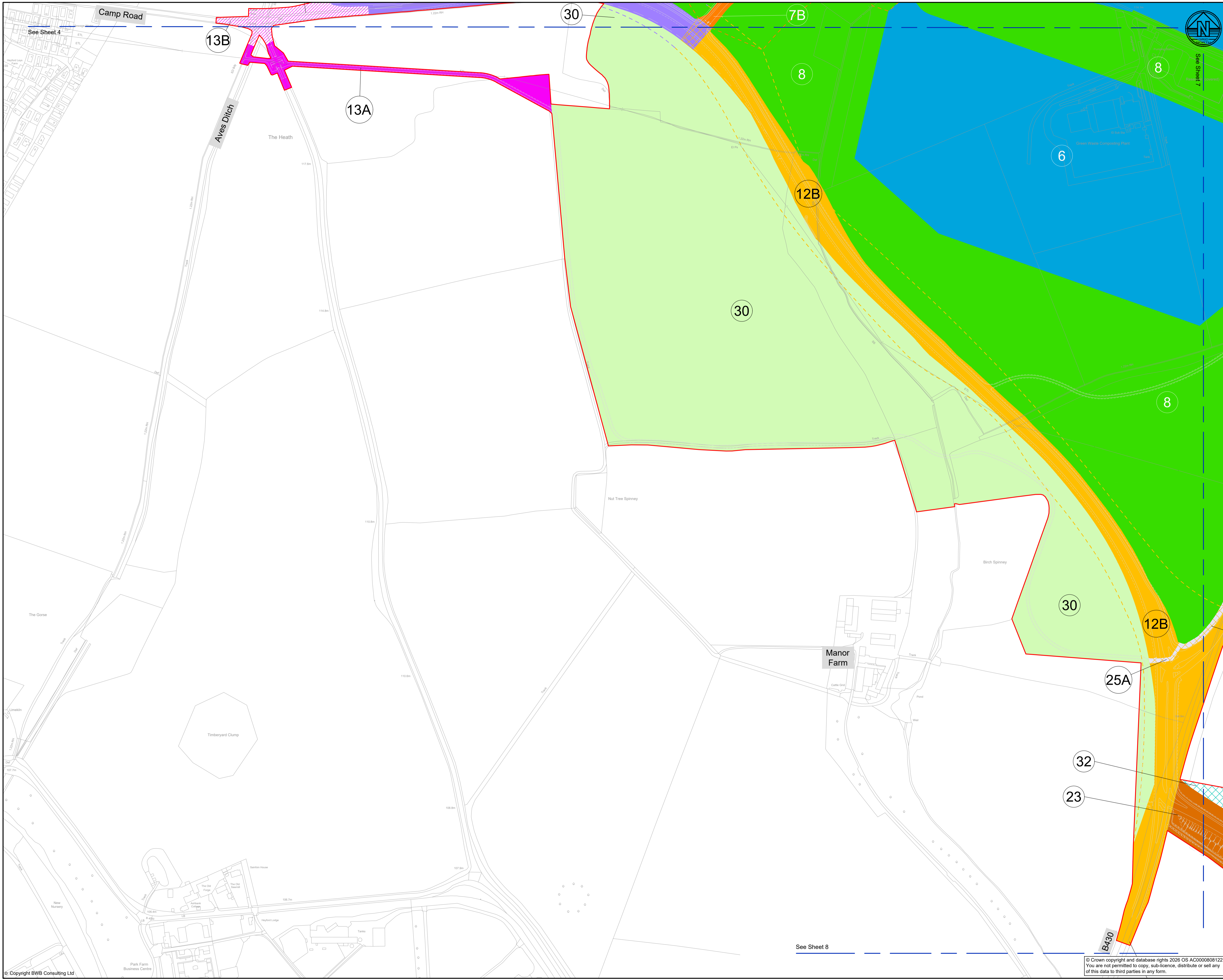

Legend (Sheet 6)

WORK No. REFERENCE

- WORK No. 6 - RAIL SERVED WAREHOUSING
- WORK No. 8 - LANDSCAPING
- WORK No. 12A - HEYFORD PARK LINK ROAD (WESTERN SECTION)
- WORK No. 12B - HEYFORD PARK LINK ROAD (EASTERN SECTION)
- WORK No. 12B AND WORK No. 25A
- WORK No. 12A LIMITS OF DEVIATION
- WORK No. 12B LIMITS OF DEVIATION
- WORK No. 12B AND WORK No. 12A
- WORK No. 13A - AVES DITCH BRIDLEWAY CONNECTION
- WORK No. 13B - CAMP ROAD/CHILGROVE DRIVE JUNCTION
- WORK No. 23 - MIDDLETON STONEY RELIEF ROAD
- WORK No. 30 - BIODIVERSITY AND LANDSCAPING ENHANCEMENT AREA (MAIN SITE)
- WORK No. 32 - ECOLOGICAL MITIGATION AREA (MIDDLETON STONEY RELIEF ROAD)
- ORDER LIMITS
- X WORK NUMBER: REFER TO SCHEDULE 1 OF THE DEVELOPMENT CONSENT ORDER.

NOTES

1. WORK No. AREAS ARE DESCRIBED IN SCHEDULE 1 OF THE DEVELOPMENT CONSENT ORDER.
2. THE LIMITS OF DEVIATION ARE THE FULL EXTENT OF THE WORKS SHOWN SAVE FOR WORK No. 12A AND 12B THE LIMITS OF DEVIATION OF WHICH ARE AS SHOWN ON THESE PLANS. PLEASE REFER ALSO TO ARTICLE 4 OF THE DEVELOPMENT CONSENT ORDER.

0 50 100 150 200
SCALE: METRES

P04	11.02.26	DCO Submission	RP	SRH	SRH
P03	23.01.26	Updated following consultation	RP	SRH	SRH
P02	29.08.25	Amended following legal review	JFP	SRH	SRH
P01	31.07.25	Preliminary Issue	JFP	SRH	SRH
Rev	Date	Details of issue / revision	Drw	CRG	APV

Issues & Revisions

Client

THE OXFORDSHIRE STRATEGIC RAIL FREIGHT INTERCHANGE AND HIGHWAYS ORDER 202X

WORKS PLANS SHEET 6 OF 10

Regulation:	5(2) (j)	Document:	2.2F
Drawn:	J.Palmer	Checked:	S.Hilditch
Approved:	S.Hilditch	Date:	31.07.2025
BWB Ref:	NTH2479	Scale@A1:	1:2500
Project - Originator - Functional Breakdown - Spatial Breakdown - Form - Discipline - Number			
OxSRFI-BWB-LSI-06-DR-CH-0166			

Drawing Status	Rev
DCO SUBMISSION	P04

© Crown copyright and database rights 2026 OS AC000080122. You are not permitted to copy, sub-licence, distribute or sell any of this data to third parties in any form.

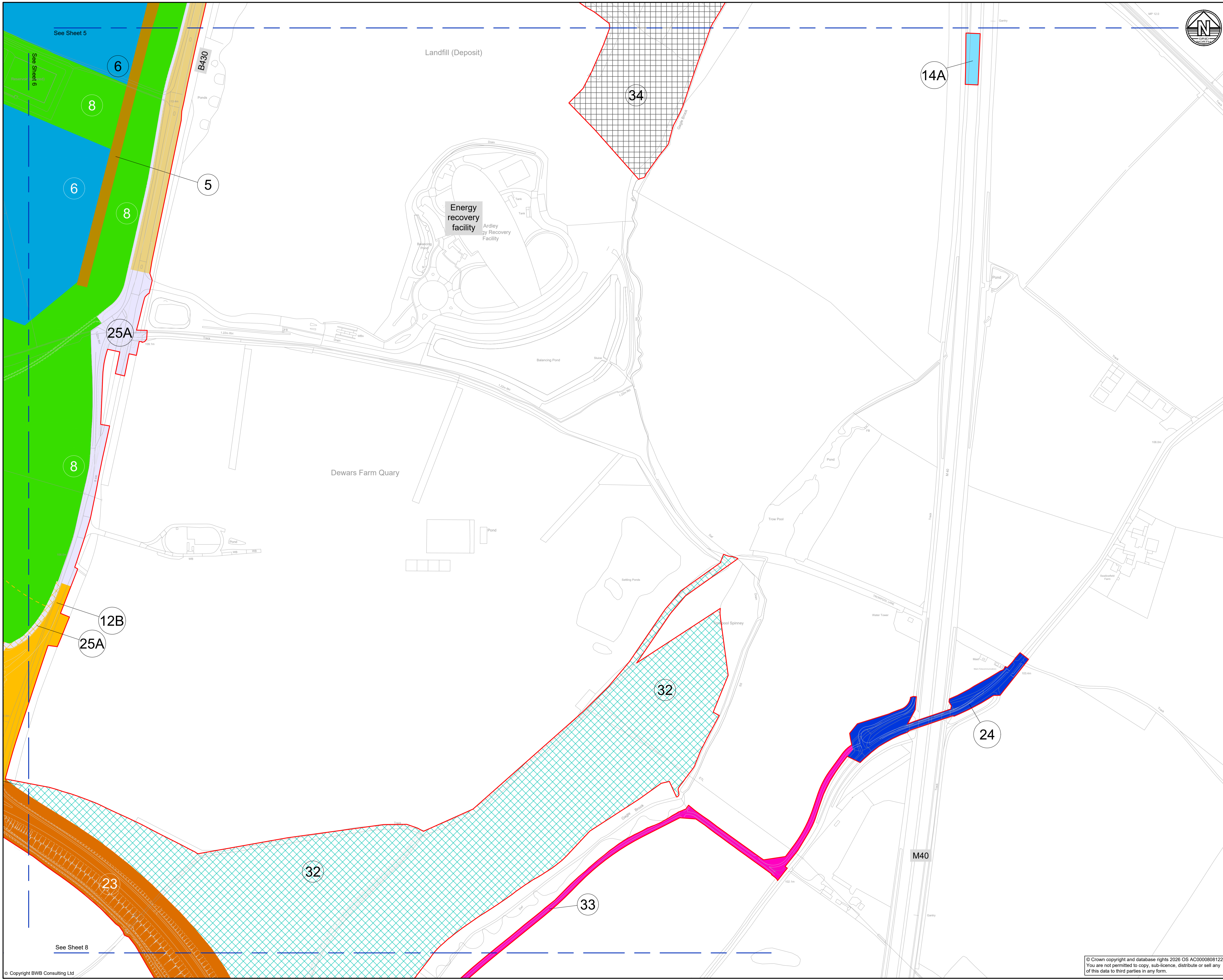

Legend (Sheet 7)

- WORK No. REFERENCE**
- WORK No. 5 - RAIL SIDINGS (WAREHOUSING)
 - WORK No. 6 - RAIL SERVED WAREHOUSING
 - WORK No. 8 - LANDSCAPING
 - WORK No. 12B AND WORK No. 25A
 - WORK No. 12B - HEYFORD PARK LINK ROAD (EASTERN SECTION)
 - WORK No. 14A - M40 J10 PHASE 1
 - WORK No. 23 - MIDDLETON STONEY RELIEF ROAD
 - WORK No. 24 - MIDDLETON ROAD
 - WORK No. 33 - CYCLE LINK TO MIDDLETON ROAD
 - WORK No. 25A - B430 ACTIVE TRAVEL ROUTE
 - WORK No. 25B - B430 UPPER HEYFORD ROAD JUNCTION
 - WORK No. 32 - ECOLOGICAL MITIGATION AREA (MIDDLETON STONEY RELIEF ROAD)
 - WORK No. 34 - LANDFILL WORKS
 - ORDER LIMITS
 - X WORK NUMBER: REFER TO SCHEDULE 1 OF THE DEVELOPMENT CONSENT ORDER.

NOTES

- WORK No. AREAS ARE DESCRIBED IN SCHEDULE 1 OF THE DEVELOPMENT CONSENT ORDER.
- THE LIMITS OF DEVIATION ARE THE FULL EXTENT OF THE WORK SHOWN. PLEASE REFER ALSO TO ARTICLE 4 OF THE DEVELOPMENT CONSENT ORDER.

0 50 100 150 200
SCALE: METRES

P05	11.02.26	DCO Submission	RP	SRH	SRH
P04	23.01.26	Updated following consultation	RP	SRH	SRH
P03	12.09.25	Minor amendments	JFP	SRH	SRH
P02	28.08.25	Amended following legal review	JFP	SRH	SRH
P01	31.07.25	Preliminary Issue	JFP	SRH	SRH
Rev	Date	Details of issue / revision	Drw	CRG	APV

Issues & Revisions

Client

THE OXFORDSHIRE STRATEGIC RAIL FREIGHT INTERCHANGE AND HIGHWAYS ORDER 202X

WORKS PLANS SHEET 7 OF 10

Regulation:	5(2) (j)	Document:	2.2G
Drawn:	J.Palmer	Checked:	S.Hilditch
Approved:	S.Hilditch	Date:	31.07.2025
BWB Ref:	NTH2479	Scale@A1:	1:2500

Project - Originator - Functional Breakdown - Spatial Breakdown - Form - Discipline - Number	
OxSRFI-BWB-LSI-07-DR-CH-0167	
Drawing Status	Rev
DCO SUBMISSION	P05

See Sheet 6

See Sheet 7

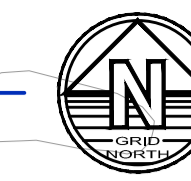

Legend (Sheet 8)

- WORK No. REFERENCE
- WORK No. 12B - HEYFORD PARK LINK ROAD PHASE 2
- WORK No. 23 - MIDDLETON STONEY RELIEF ROAD
- WORK No. 33 - CYCLE LINK TO MIDDLETON ROAD
- WORK No. 27A - ARDLEY ROAD (MIDDLETON STONEY)
- WORK No. 27B - MIDDLETON STONEY CROSSROADS
- WORK No. 31 - BIODIVERSITY AND LANDSCAPING ENHANCEMENT AREA (WOODLAND PLANTING)
- WORK No. 32 - ECOLOGICAL MITIGATION AREA (MIDDLETON STONEY RELIEF ROAD)
- WORK No. 35 - FOUL SEWER OUTFALL TO BICESTER
- ORDER LIMITS
- WORK NUMBER: REFER TO SCHEDULE 1 OF THE DEVELOPMENT CONSENT ORDER.

NOTES

- WORK No. AREAS ARE DESCRIBED IN SCHEDULE 1 OF THE DEVELOPMENT CONSENT ORDER.
- THE LIMITS OF DEVIATION ARE THE FULL EXTENT OF THE WORK SHOWN. PLEASE REFER ALSO TO ARTICLE 4 OF THE DEVELOPMENT CONSENT ORDER.

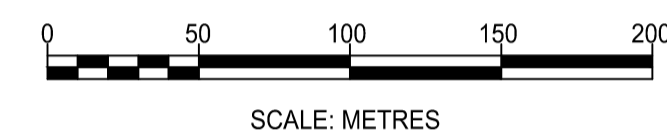

P05	11.02.26	DCO Submission	RP	SRH	SRH
P04	23.01.26	Updated following consultation	RP	SRH	SRH
P03	12.09.25	Minor Amendments	JFP	SRH	SRH
P02	29.08.25	Amended following legal review	JFP	SRH	SRH
P01	31.07.25	Preliminary Issue	JFP	SRH	SRH
Rev	Date	Details of issue / revision	Drw	CRG	APV

Issues & Revisions

Client

Project Title
THE OXFORDSHIRE STRATEGIC RAIL FREIGHT INTERCHANGE AND HIGHWAYS ORDER 202X

Drawing Title
WORKS PLANS SHEET 8 OF 10

Regulation:	5(2) (j)	Document:	2.2H
Drawn:	J.Palmer	Checked:	S.Hilditch
Approved:	S.Hilditch	Date:	31.07.2025
BWB Ref:	NTH2479	Scale@A1:	1:2500

Project - Originator - Functional Breakdown - Spatial Breakdown - Form - Discipline - Number
OxSRFI-BWB-LSI-08-DR-CH-0168

Drawing Status	Rev
DCO SUBMISSION	P05

© Crown copyright and database rights 2026 OS AC0000808122. You are not permitted to copy, sub-licence, distribute or sell any of this data to third parties in any form.

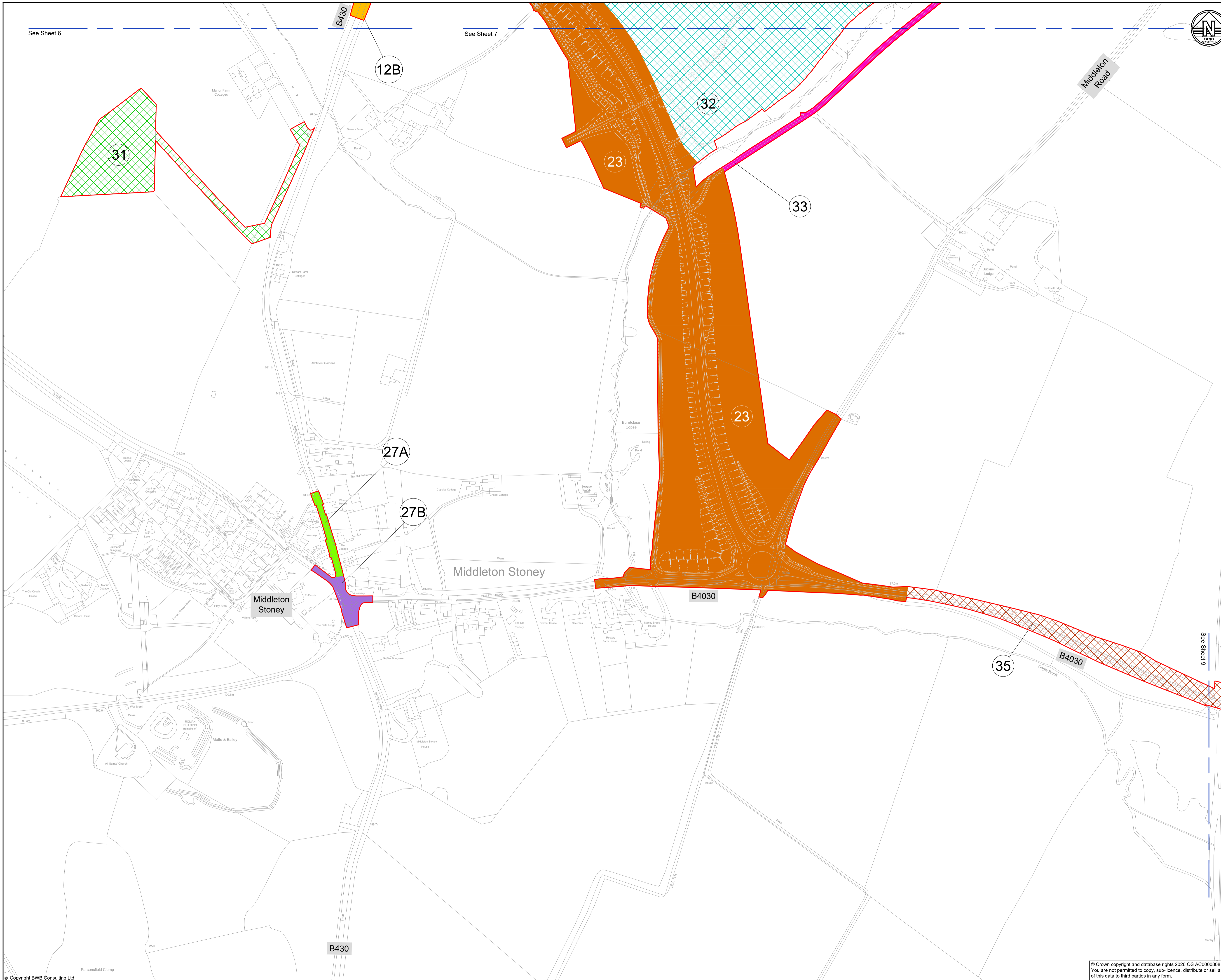

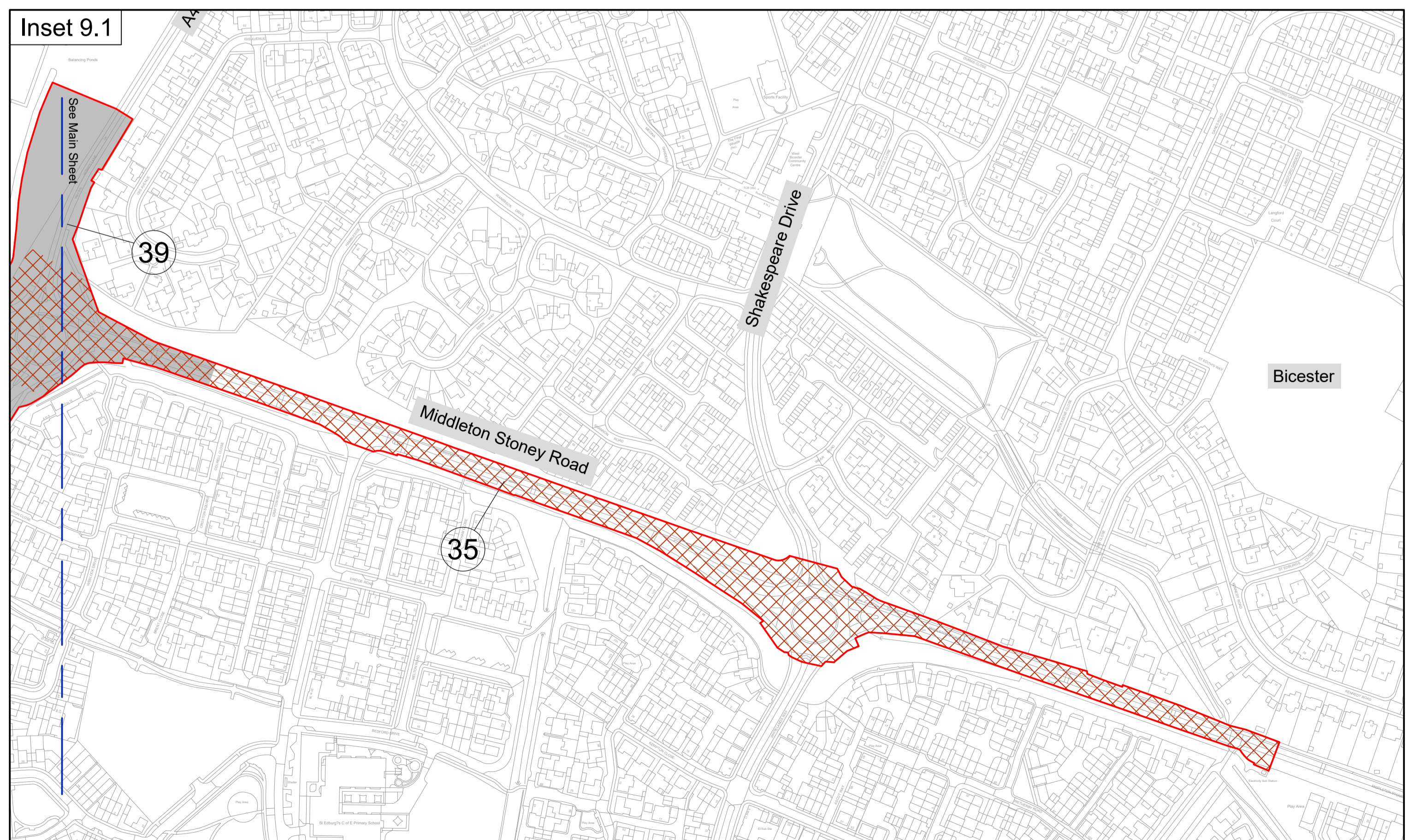
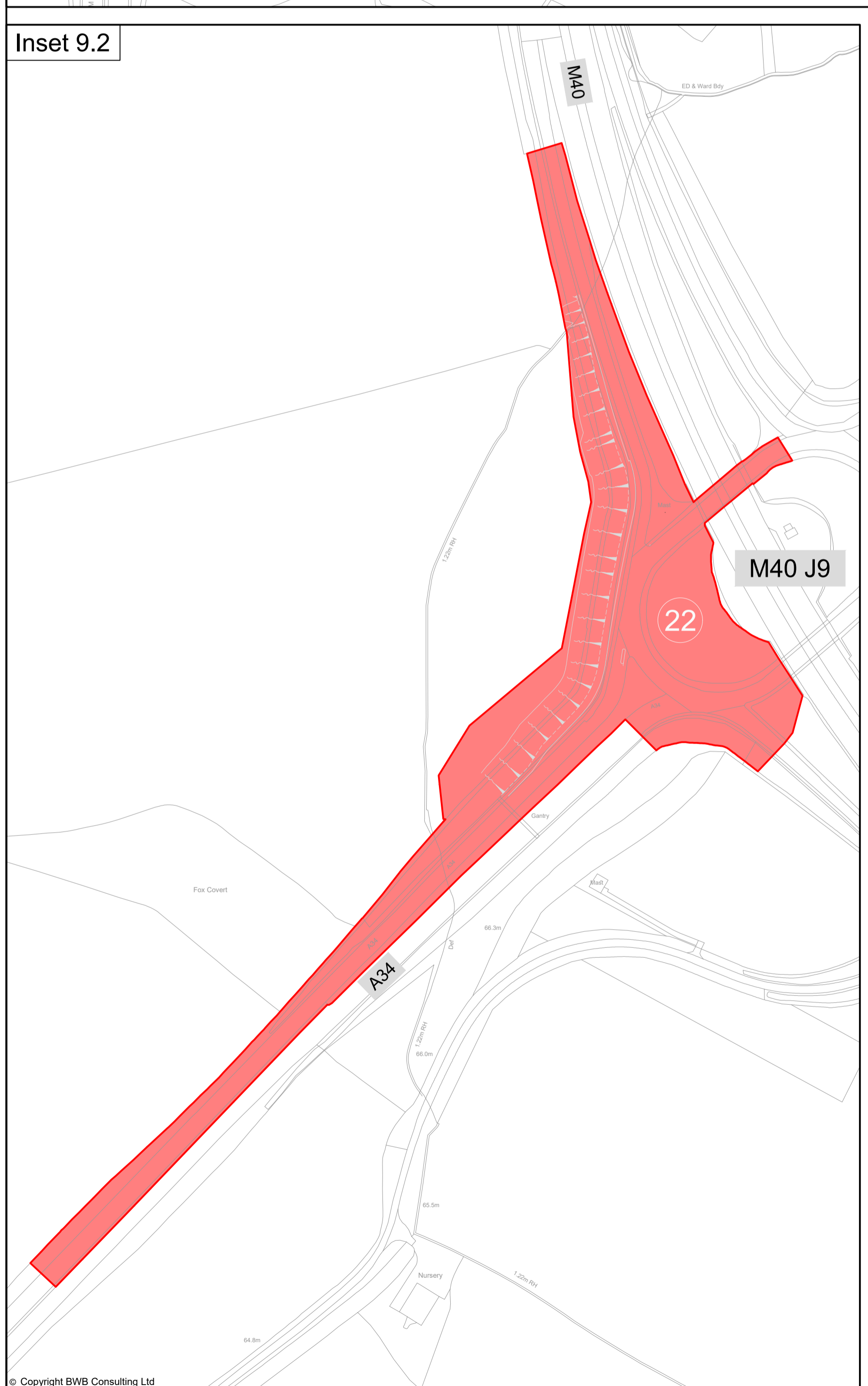
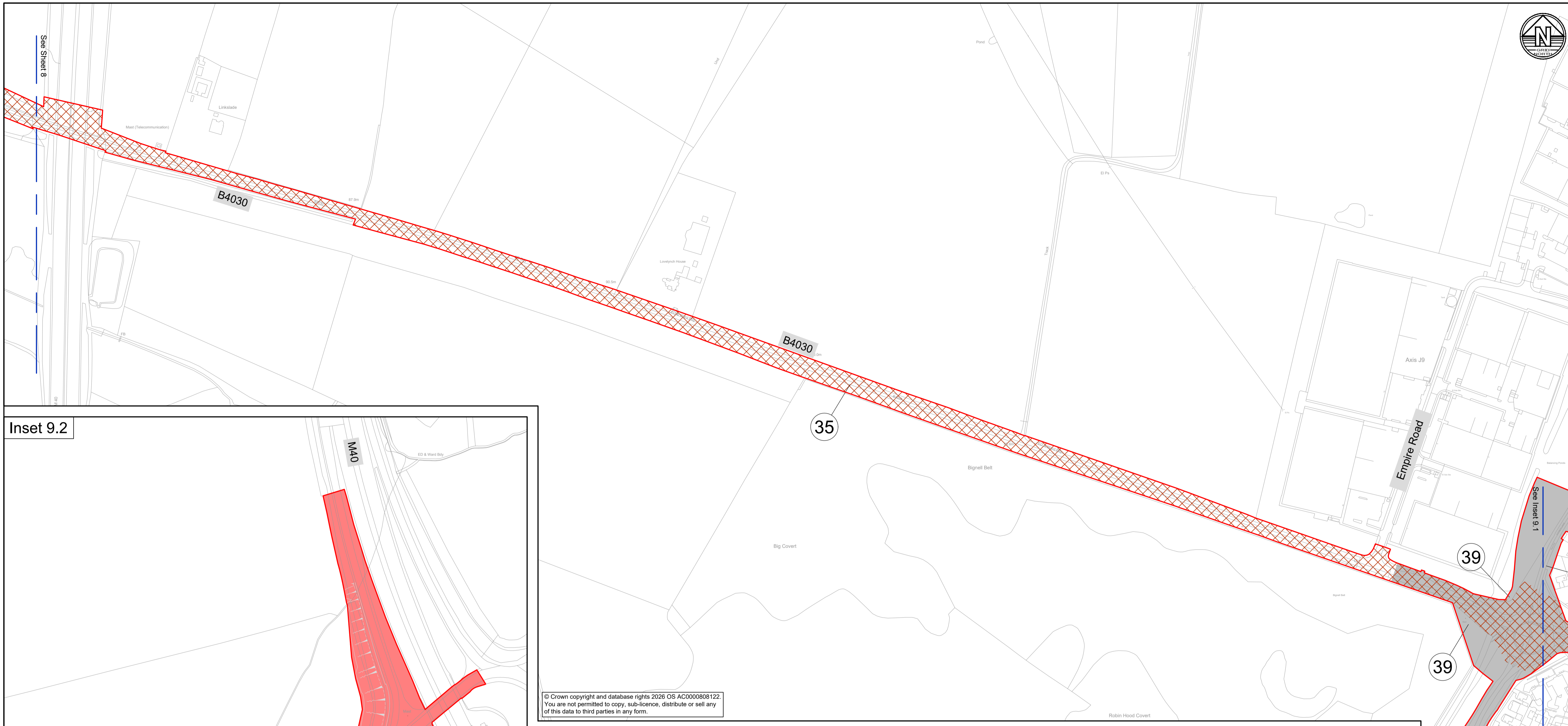

Legend (Sheet 9)

WORK No. REFERENCE

- WORK No. 22 - M40 JUNCTION 9
- WORK No. 35 - FOUL SEWER OUTFALL TO BICESTER
- WORK No. 39 - A4095/B4030 ROUNDABOUT
- WORK No. 39 AND WORK No. 35
- ORDER LIMITS
- X WORK NUMBER: REFER TO SCHEDULE 1 OF THE DEVELOPMENT CONSENT ORDER.

NOTES

1. WORK No. AREAS ARE DESCRIBED IN SCHEDULE 1 OF THE DEVELOPMENT CONSENT ORDER.
2. THE LIMITS OF DEVIATION ARE THE FULL EXTENT OF THE WORK SHOWN. PLEASE REFER ALSO TO ARTICLE 4 OF THE DEVELOPMENT CONSENT ORDER.

0 50 100 150 200
SCALE: METRES

Rev	Date	Details of issue / revision	Drw	CRG	APV
P05	11.02.26	DCO Submission	RP	SRH	SRH
P04	23.01.26	Updated following consultation	RP	SRH	SRH
P03	12.09.25	Addition of Work No. 39 and 40	JFP	SRH	SRH
P02	29.08.25	Amended following legal review	JFP	SRH	SRH
P01	31.07.25	Preliminary Issue	JFP	SRH	SRH

Issues & Revisions

Client

THE OXFORDSHIRE STRATEGIC RAIL FREIGHT INTERCHANGE AND HIGHWAYS ORDER 202X

WORKS PLANS SHEET 9 OF 10

Regulation:	5(2) (j)	Document:	2.21
Drawn:	J.Palmer	Checked:	S.Hilditch
Approved:	S.Hilditch	Date:	31.07.2025
BWB Ref:	NTH2479	Scale@A1:	1:2500
Project - Originator - Functional Breakdown - Spatial Breakdown - Form - Discipline - Number			
OxSRFI-BWB-LSI-09-DR-CH-0169			
Drawing Status			Rev
DCO SUBMISSION			P05



Legend (Sheet 10)

- WORK No. REFERENCE
- WORK No. 38 - ARDLEY TUNNEL
- ORDER LIMITS
- X WORK NUMBER: REFER TO SCHEDULE 1 OF THE DEVELOPMENT CONSENT ORDER.

- NOTES**
1. WORK No. AREAS ARE DESCRIBED IN SCHEDULE 1 OF THE DEVELOPMENT CONSENT ORDER.
 2. THE LIMITS OF DEVIATION ARE THE FULL EXTENT OF THE WORK SHOWN. PLEASE REFER ALSO TO ARTICLE 4 OF THE DEVELOPMENT CONSENT ORDER.

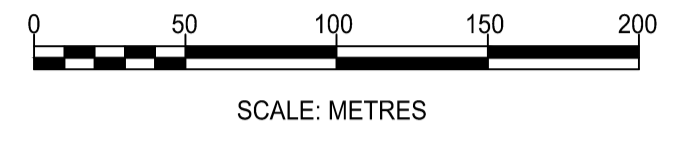

P03	11.02.26	DCO Submission	RP	SRH	SRH
P02	23.01.20	Updated following consultation	RP	SRH	SRH
P01	29.08.25	Preliminary Issue	JFP	SRH	SRH
Rev	Date	Details of issue / revision	Drw	CRG	APV

Issues & Revisions

Client

THE OXFORDSHIRE STRATEGIC RAIL FREIGHT INTERCHANGE AND HIGHWAYS ORDER 202X

WORKS PLANS SHEET 10 OF 10

Regulation:	5(2) (j)	Document:	2.2J
Drawn:	J.Palmer	Checked:	S.Hilditch
Approved:	S.Hilditch	Date:	29.08.2025
BWB Ref:	NTH2479	Scale@A1:	1:2500

OxSRFI-BWB-LSI-12-DR-CH-0162A

Drawing Status	Rev
DCO SUBMISSION	P03

See Sheet 2

© Crown copyright and database rights 2026 OS AC0000808122. You are not permitted to copy, sub-licence, distribute or sell any of this data to third parties in any form.